

of

Lot 2 of Certified Survey Map No. 4700,
recorded in Vol. 31 of Certified Survey Maps of Walworth County on Page 82
and located in the Southeast 1/4 of the Northwest 1/4 of Section 25, Town 2
North, Range 17 East, Town of Geneva, Walworth County, Wisconsin.

Bearings referenced to the West line of Certified Survey Map No. 4700, recorded as N0°05'00"E, which produces a bearing of N0°02'19"E on the East line of the Northwest 1/4 of Section 25-2-17. A rotation of -0°41'03" from the Wisconsin State Plane Coordinate System, South Zone, (NAD-27).

Coordinates are referenced to the Wisconsin State Plane Coordinate System, South Zone, (NAD-27).



45 South Wisconsin Street | P.O. Box 322
Elkhorn, Wisconsin. 53121
Telephone: (262) 723-3434
Facsimile: (262) 723-8044
Email: doug@olsonsurveying.com
Website: www.olsonsurveying.com

OLSON
LAND SURVEYING, LLC
Rural | Residential | Commercial

() Found Iron Pipe
 () Set Wood Stake
 () Recorded Information
 () Utility Pole
 () Utility Pedestal
 () Concrete Cover
 () Asphalt Surface
 () Concrete Surface
 () Septic Vent
 () Manhole
 () Lamp
 () Brick Pavers
 () Gravel Surface
 " South
 " East
 " West
 " In Bearings
 " Degrees
 " Minutes
 " Seconds
 " In Distances
 " Feet
 " Inches

Drawing Name:

Job Reference Number

2022.135

022.135

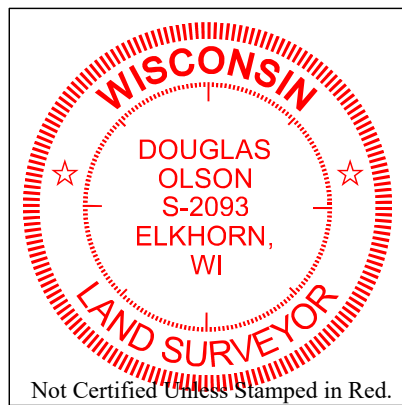

- 1) This Plat of Survey is not certified unless signed and sealed in red ink.
- 2) This survey is subject to Wisconsin lien laws. This Plat of Survey is the notice of intent to file lien. Lien waiver required.
- 3) The Survey Date shown on this Plat of Survey is the completion date of the field work.

All rights reserved. No part of this survey plat may be reproduced or transmitted in any form by any means - graphic, electronic, or mechanical, including photocopying, tracing, or information storage and retrieval systems - without permission in writing from Douglas G. Olson, Olson Land Surveying, LLC.

I hereby certify that I have surveyed the above described property in compliance with Chapter A-E 7 of the Wisconsin Administrative Code and that the map hereon is correct to the best of my professional knowledge and belief and shows the size and location of the property, its exterior boundaries, the location and dimensions of all visible structures thereon, boundary fences, apparent easements and roadways and visible encroachments, if any.

This survey is made for the exclusive use of the present owners of the property, and also those who purchase, mortgage or guarantee title thereto, within one year from the date hereof.

Douglas G. Olson
Wisconsin Professional Land Surveyor - 2093